

# DODGE COUNTY MOVING PERMIT APPLICATION

For Buildings over 12 feet in Width

Number 246

COPY

Appendix Item # 2/e  
Date 1-30-2019

1. THAT, The Applicant, Charles Lange, applies to move a move 45' x 28' barn over the Public Right-of-Way in Dodge County, Nebraska on 2 2019 over the following route per attached map.
2. THAT, the Applicant does hereby agree to hold the County of Dodge, Officers, Agents, or Employees forever harmless from any and all liabilities resulting from said move.
3. THAT, the Applicant shall provide all barricades, flags, flag people, vehicles, and warning lights necessary for adequate warning to other road users.
4. THAT, the Applicant hereby submits a Certified Check in the amount of \$500.00 made payable to the Dodge County Highway Department, which shall become the property of Dodge County as liquidated damages, if any signs, bridges, or any other county or township property is damaged, as well as tree trimmings, moving blocks, and any other tools that are left remaining in Dodge County's Right-of-Way. The Check will be returned after 5 days from the date of permit application if all of the above requirements are met.
5. THAT, the Applicant shall submit an **Insurance Certificate** with this application, verifying General Liability of \$1,000,000.00; Personal Injury of \$500,000.00; Medical Expense (Any one person) of \$5,000.00; Each Occurrence of \$500,000.00.

Charles Lange  
Signature of Applicant

\_\_\_\_\_  
Applicant's Address

1-30-19  
Date Filed with Dodge County Board of Supervisors

2019 JAN 22 AM 10:31  
RECEIVED  
Dodge Co Highway Dept

T-19-N

# EVERETT DIRECTORY

(Residents - Owners or Renters)

R-7-E

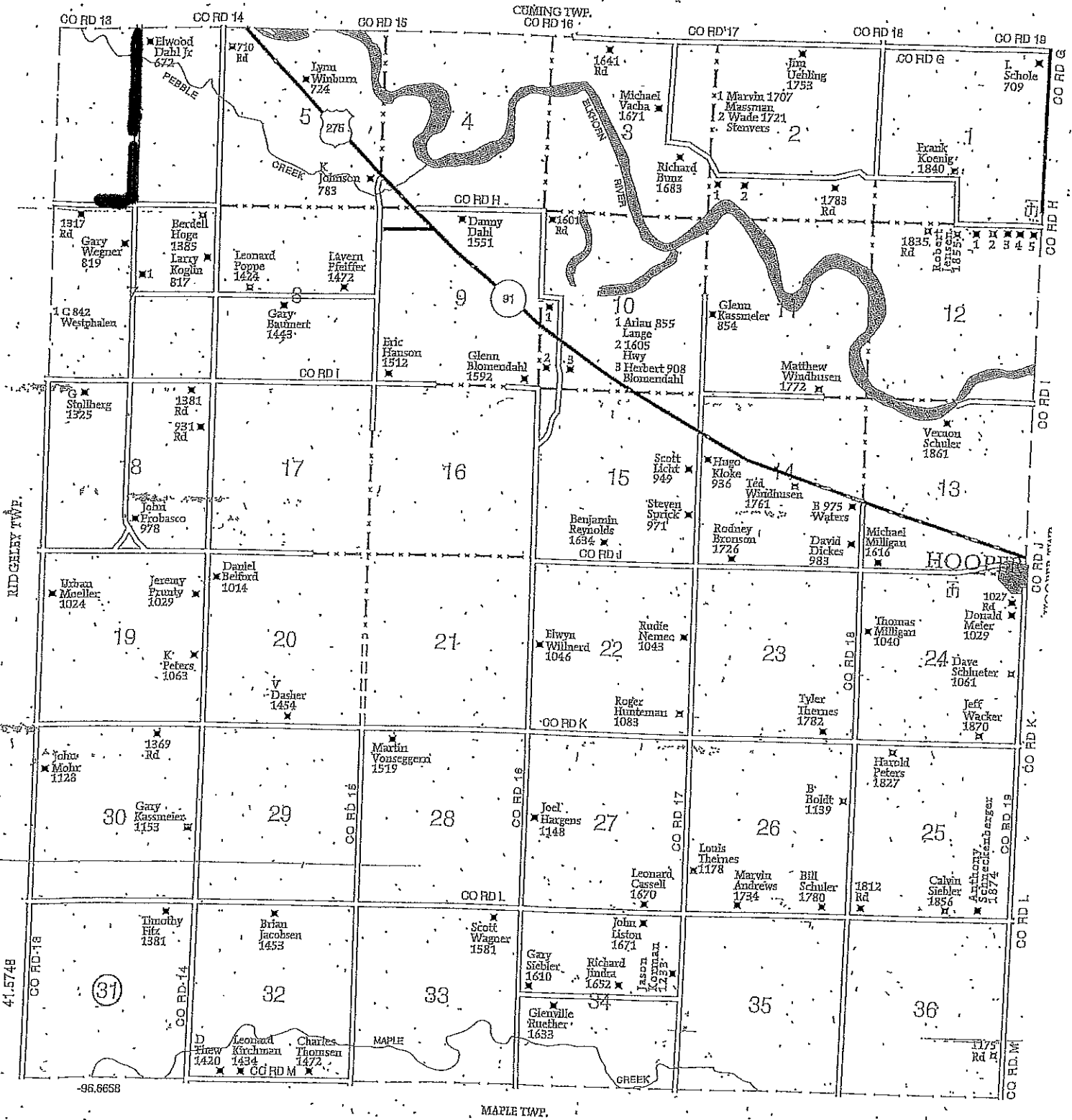

-96.8658

MAPLE TWP.